



# Utah's Unified State Laboratories: Lessons Learned

---

## Science Gazing Symposium

Patrick F. Luedtke MD, MPH

Utah Department of Health

# PHL Challenges in 2020: My “FEARs”

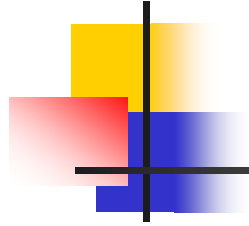

1. **F**unding: The growing “Pay-Go” & fee-for-service environment
2. **E**mployees: the workforce you have/need
3. **A**dvancements: scientific, social, political
4. **R**elevance: outbreaks, NBS, BT/CT, TB, rabies

# Addressing FEARs Via A Building



---

Find the possible

Study the probable

Build the defensible

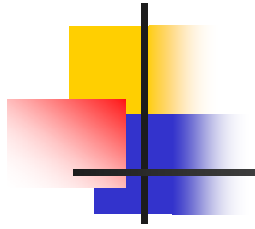

## Remember This....

---

“The possible” is limited only by your vision.



And This.....

---

You are creating a Building, Site,  
and System Masterplan

# The Masterplan "FEAR" Built





Find the Possible!



# What's Possible?







# What's Possible?

---

1. Exterior landscape: Georgia
2. Exterior building: MN, AZ, Georgia
3. Interior:
  - a.) Virginia: PH Lab on steroids
  - b.) Georgia: Frank Lloyd Wright meets  
Martha Stewart
  - c.) CDC Atlanta

# What's Possible?

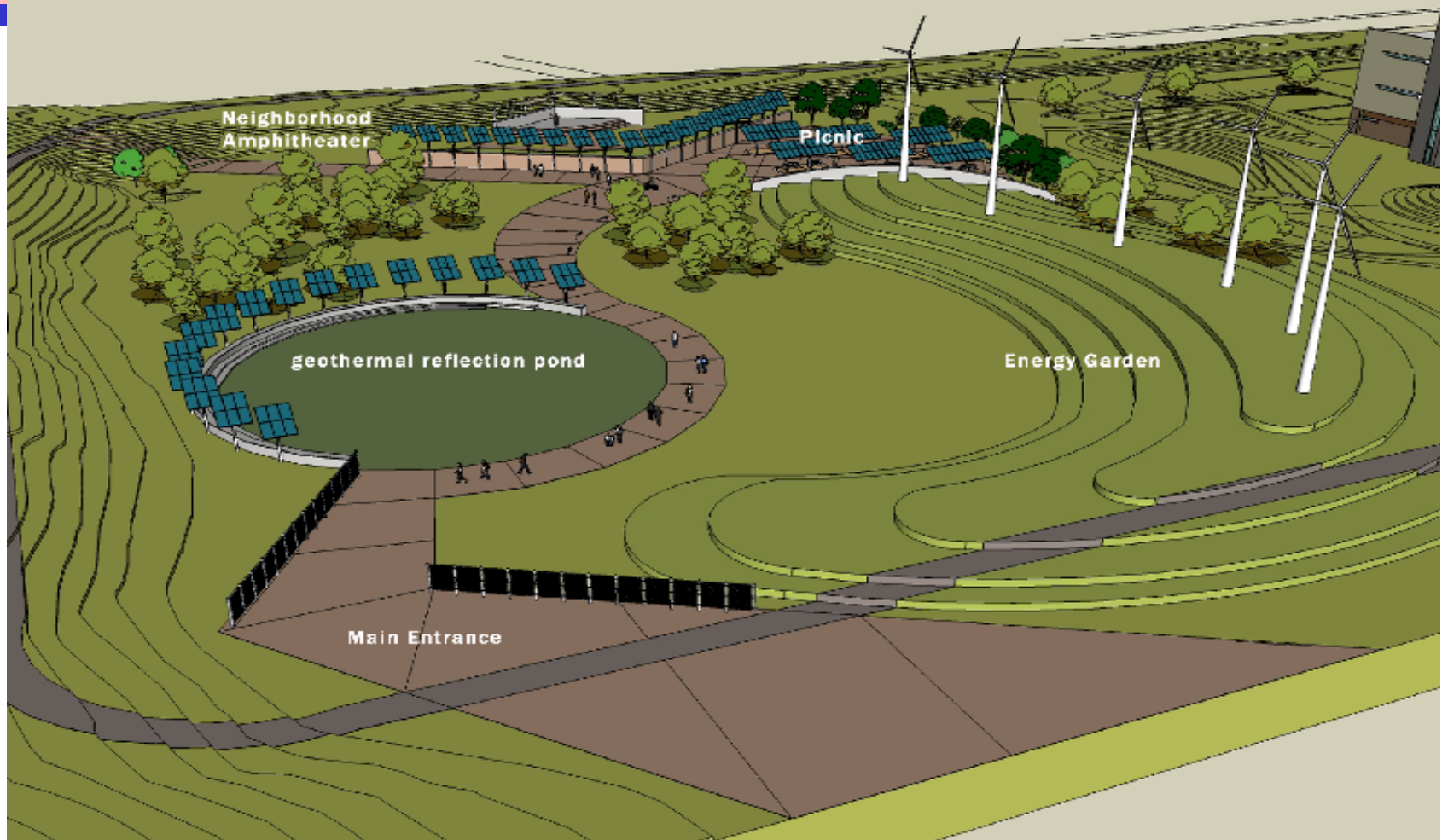

# Study the Probable



# What's Defensible



# The PHLD Role: Determine Philosophy Drivers



---

1. Safety & Scientific Excellence
2. Flexibility
3. Create a building everyone will want to work in
4. Energy Efficiency
5. Forced External & Internal Collaboration

# Philosophy Drivers & the Horizon

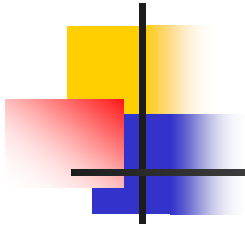

Testing Increases:

Biomonitoring

Molecular

Multiplexing

NBS

Testing Decreases:

Single analyte testing

Serology/Immunology

Routine culture

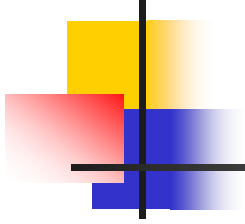

See you in 2020!



# Critical Issues: Getting Funded

---

- First and foremost, know what you want (philosophy drivers)
- Second, know how your building request is “graded”
- Third, produce a document identifying your want
- Fourth, identify with whom to share these wants/needs
- Fifth, tell everyone, every thing, all the time